

Jet PAR7ZIP

7x20W IP65 RGB+WW zoom LED PAR

ORDER CODE: JETPAR7ZIPBK



Jet Par7ZIP is a flexible IP65 rated LED zoom PAR featuring a 7x20W RGB + WarmWhite LED source delivering phenomenal output and great flexibility for both indoor and outdoor application.

Its Spektra calibrated LED source delivers a high-quality white reproduction with high CRI and TLCI scores as well as an extremely precise colour tuning.

Jet Par7ZIP is truly focusable through the motorized zoom system ranging from 4.5° to 53°, being a truly versatile workhorse for any application requiring an advanced control of the light and weatherproof.

MAIN FEATURES

- 7x20W Spektra calibrated RGB + Warm White LED delivering high CRI, TLCI, TM30 values
- 4.5° to 53° motorized linear zoom
- IP65 for exterior applications

TECHNICAL SPECIFICATION

LIGHT SOURCE

- Source: 7x20 W RGB + Warm White LED
- Luminous flux: preliminary data: (4,5°) 1'229 lm - (53°) 2'108 lm @full
- Lux: preliminary data: (4,5°) 27'888 lx - (53°) 720 lx @3 m full
- CRI: preliminary data: 93,8 @ 3'200K; 92,5 @ 5'600K
- R9: preliminary data: 93,4 @ 3'200K; 79 @ 5'600K
- Source life expectancy: > 50.000 h

OPTICS

- Zoom: 4,5° - 53 ° motorised linear zoom
- Lens type: honeycomb gapless plano-convex optics
- COLOUR SYSTEM
- Colour mixing: RGBW / FC
- CCT: CCT control, + / - green correction, tungsten emulation
- White presets: 2.800 K ~ 10.000 K
- Colour wheel: gel filters included

DYNAMIC EFFECTS

- Control Resolution: 16-bit dimmer
- Special features: linear crossfade channel from any white to any colour; virtual CTO on colours

BODY

- Body: weatherproof IP65 construction
- Body colour: black
- Other: Front mount holder for accessories as Barn door, filter frame

CONTROL

- Protocols: DMX512, RDM, CRMX + WDMX, 3 push encoder
- DMX channels: 1 / 2 / 6 / 12 / 14 / 20 channel
- Wireless Control: optional, LumenRadio Timo Fx DMX/RDM compatible with both CRMX (Lumen Radio) and W-DMX (Wireless DMX)

- RDM: RDM for remote monitoring and settings
- Display: LCD high resolution colour display
- Firmware upgrade: yes, via USB - DMX interface (UPBOX2) not included

ELECTRONICS

- Dimmer: linear 0 ~ 100% electronic dimmer
- Dimmer curves: 4 selectable dimming modes available
- Strobe / shutter: 1 - 30 Hz, electronic
- Operating temperature: -20° C / +45° C (-4° F / +113° F)
- LED Control: flicker free operation
- Selectable PWM: 600 ~ 50.000 Hz

ELECTRICAL

- Mains power supply: 100-240V - 50/60Hz
- Max power consumption: 127 W
- Output (at 230V): 16 units on a single power line
- Power factor: > 0,95

PHYSICAL

- IP rating: 65 for outdoor installations
- Cooling: active, silent operation
- Suspension and fixing: double hanging bracket suitable for safe hanging and for floor positioning
- Signal connection: Seetronic XLR 5p IN/OUT connectors
- Power connection: Seetronic powerCON TRUE IP65 IN/OUT
- Dimensions (WxHxD): 291x347x300 mm
- Weight: 9,3 kg
- (*) NOTE: Suitable for permanent outdoor use, provided installation and maintenance cycles by qualified technicians are carried.

CERTIFICATIONS / APPROVALS

- Certifications / Approvals: CE, UKCA, RCM

ACCESSORIES & RELATED PRODUCTS

- AJP7ZIPBAG1U Empty ABS case for 1 pc of ASTRAPAR7ZIP or JETPAR7ZIP
- FCLAJP7ZIP Flight case for 6 pcs ASTRAPAR7ZIP / JETPAR7ZIP
- AJP7ZIPBDBK Barn door with 8 directional flaps to adjust the light beam
- AJP7ZIPFFBK Filter frame for ASTRAPAR7ZIP e JETPAR7ZIP
- IPTTESTBOX Portable vacuum and pressure tester for ProLights IP fixtures
- C6002B Slim aluminum clamp, 200kg loading, 48-51mm tubes, M10 bolt, Black
- RSR0670B Steel security cable for hanging bodies, inox steel shackle, L=60 cm, black
- 9333FXWL03 Ass. 3x2.5mm TH07 cable, SHUKO plug, SETSAC3FX socket, L.3m

- 9313FXWL03 Ass. 3x2.5mm TH07 cable, 16A 3p 230V CEE plug, SETSAC3FX socket, L.3 m
- 938225L03 3x2.5mm TH07 Cable, 16A SETSAC3MX, 16A SETSAC3FX, L. 3m
- INF53415L03 Dmx cable HC5340. SETMC5MXXB XLR 5p->SETMC5FXXB XLR (f) 5p L.3m
- LRLUNA Single Universe DMX transceiver with Bluetooth
- SPGM10 28mm spigot for fixtures, M10 bolt
- SPGM12 28mm spigot for fixtures, M12 bolt
- UPBOXPRO Firmware uploader kit, USB IN, 5-pin XLR DMX OUT connector
- UPBOX2P5 Firmware uploader kit, USB IN, 5-pin XLR DMX OUT

PRESET FULL ON

Beam angle 50%: 4,5°

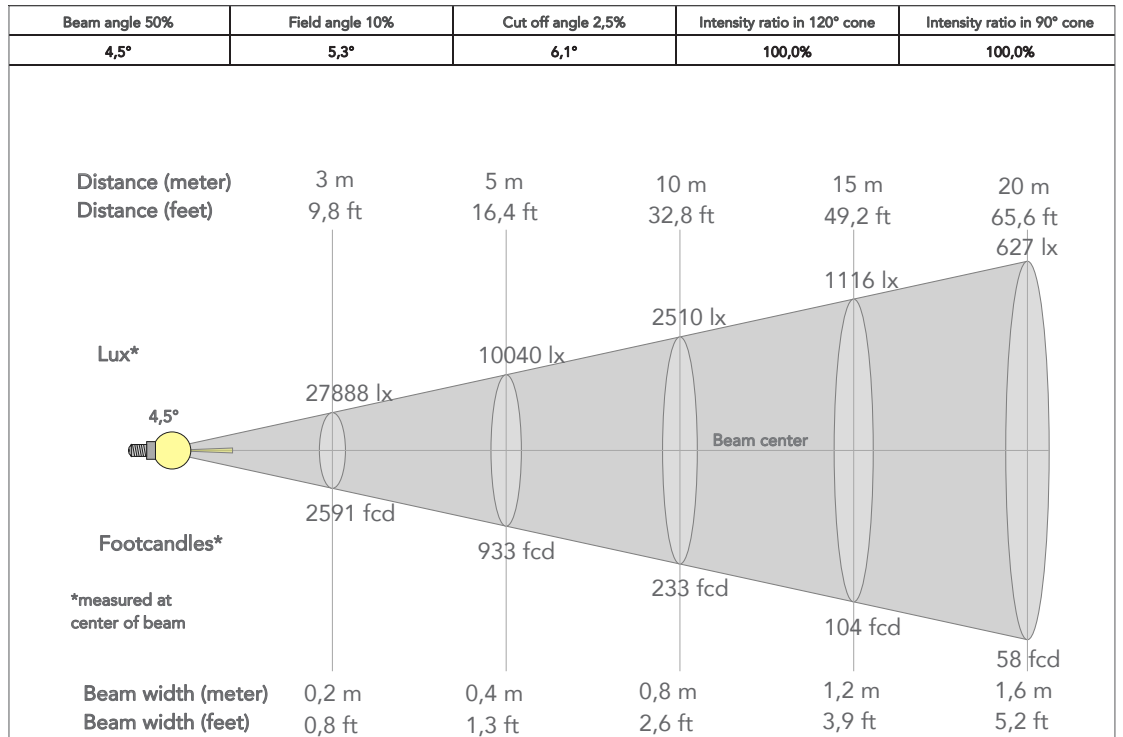

PRESET FULL ON

Beam angle 50%: 49,7°

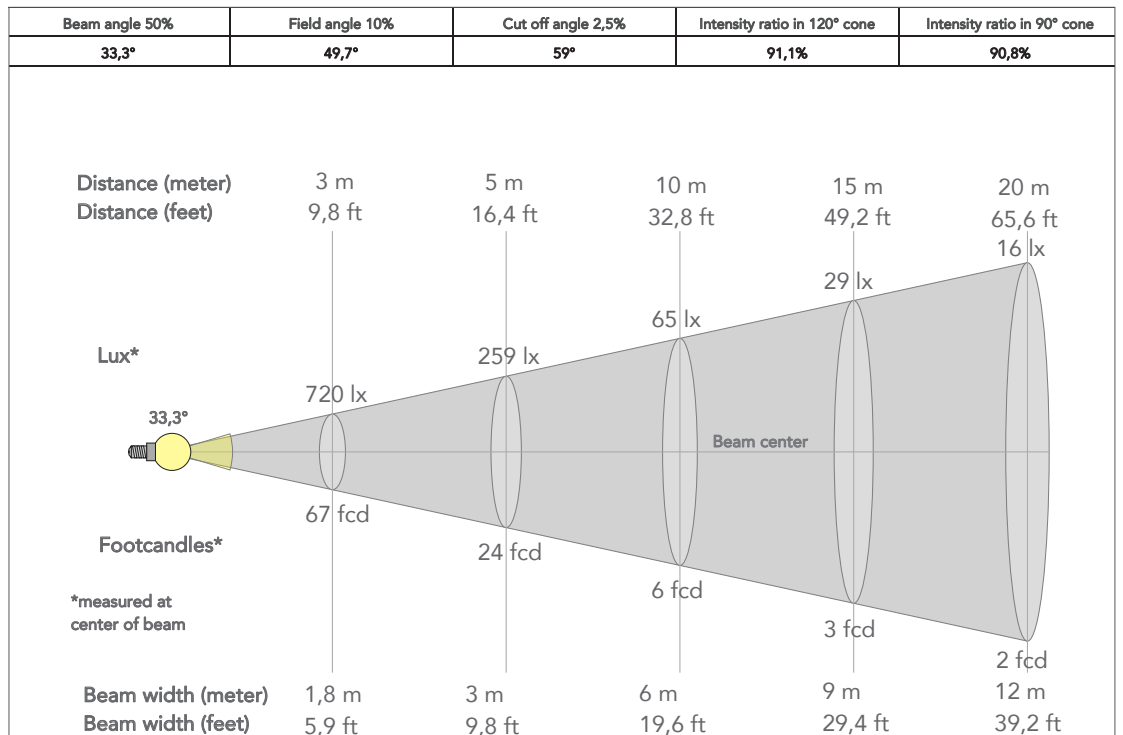

TECHICAL DRAWINGS

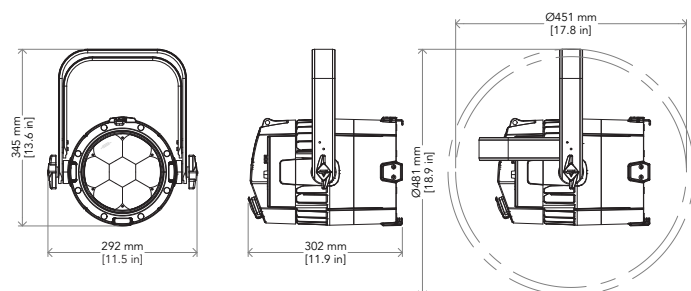

CERTIFICATIONS / APPROVALS



Conforms to UL STD. 1573
Certified to CSA STD: C22.2 NO. 166

Visit our website for specifications and tech documentations

